

# ATEX

Offshore And Subsea Products

*Or Blok*

Australia

Lifting & Hoisting Equipment



OFFSHORE AND SUBSEA PRODUCTS

**Technical basis**

In Directive 94/9/EC, equipment for areas with an explosion hazard is assigned to groups, categories and temperature classes. This is necessary as the requirements for equipment need not be the same for every application and for every hazard classification.

**group I Equipment group I (mines, firedamp and combustible dusts)**

Category M1	Category M2
Very high level of protection: Equipment must feature integrated explosion protection measures	High level of protection: Protection measures must ensure the required level of safety during normal operation also under arduous conditions and in particular heavy handling and under changing ambient conditions
The equipment must continue to operate in an explosive atmosphere even in the event of rare faults	It must be possible to switch off the equipment if an explosive atmosphere occurs

**group II**

**Equipment group II (explosive atmospheres caused by mixtures of gas/air or dust/air, vapours or mists)**

Category	Zone		Equipment safety	Explosive atmosphere
	G[ Gas]	D[ Dust]		
1	0	20	Equipment which ensures a very high level of safety. In the event of rare equipment faults.	Intended for use in areas in which explosive atmospheres caused by mixtures of air and gases, vapours or mists or by air/dust mixtures are present continuously, for long periods or frequently.
2	1	21	Equipment which ensures a high level of safety. If equipment faults are to be expected.	Intended for use in areas in which explosive atmospheres caused by mixtures of air and gases, vapours or mists or by air/dust mixtures are likely to occur occasionally.
3	2	22	Equipment which ensures a normal level of safety. For normal operation	Intended for use in areas in which explosive atmospheres caused by gases, vapours or mists or whirled up dust are unlikely to occur or, if they do occur, are likely to do so only infrequently and for a short period.

**Temperature classes**

The ignition temperature is the lowest temperature of a heated surface at which the gas/air or vapour/air mixture ignites. In other words, it represents the lowest temperature value at which a hot surface is capable of igniting the corresponding explosive atmosphere. Thus the highest surface temperature of any equipment must always be less than the ignition temperature of the gas/air or vapour/air mixture.

**Temperature classes**

Temperature classes	Permissible max. surface temperature of the equipment	Ignition temperature range of the mixtures
T1	450° C	>450° C
T2	300° C	>300 ... ≤ 450° C
T3	200° C	>300 ... ≤ 300° C
T4	135° C	>135 ... ≤ 200° C
T5	100° C	>100 ... ≤ 135° C
T6	85° C	> 85 ... ≤ 100° C

**Explosion groups**

Equipment of group II, for appropriate use in explosive gas atmospheres may also be classified by the type of explosive area.

**Explosion groups**

Explosion group of the explosive atmosphere	Equipment with marking of the explosion group which may be used in these atmospheres	Maximum experimental safe gap
IIA	IIA, IIB, IIC	>0.9 mm
IIB	IIA, IIB	≤ 0.9 - ≥ 0.5 mm
IIC	IIC	<0.5 mm

( IEC60079-12 )

( MIC )

This classification is based on the Maximum Experimental Safe Gap (MESG) and the Minimum Ignition Current (MIC) of the gas mixture (see IEC 60079-12) or the explosion groups can also be used for classification of the equipment based on their inflammability.

**Marking key**

Example	Ⓔ	II	2	GD	c	IIC	T4	IIIC	T135°C
---------	---	----	---	----	---	-----	----	------	--------

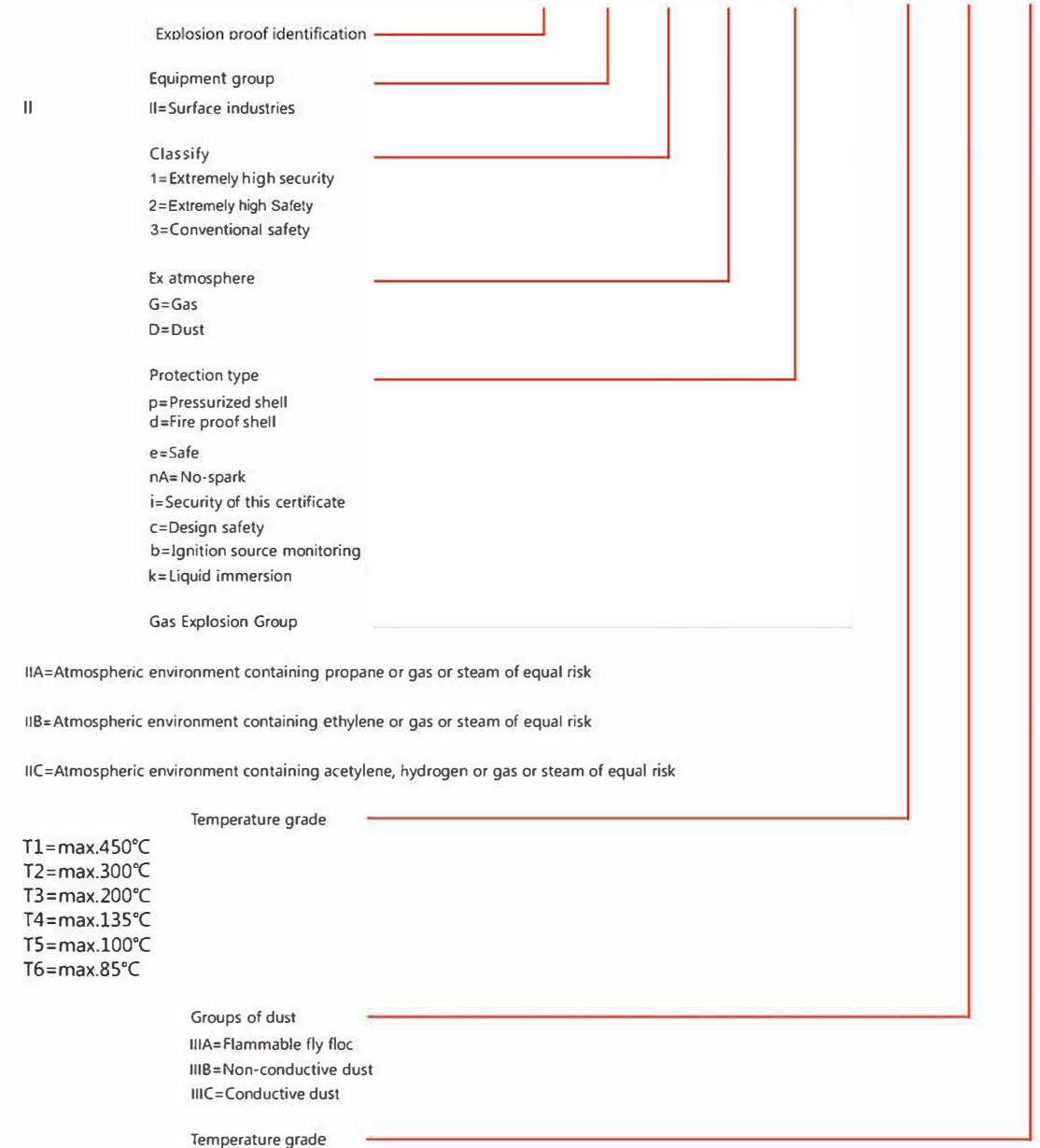

# SSGCL Anti-corrosion Geared Trolley



**Or Blok**  
Australia  
Lifting & Hoisting Equipment

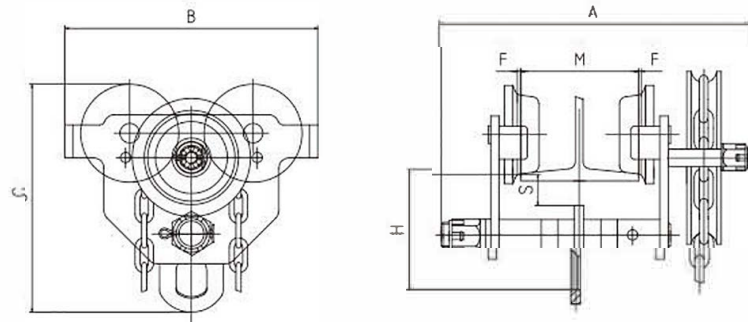

Model		GCL-1	GCL-2	GCL-3	GCL-5	GCL-10	GCL-20	GCL-30	
Capacity	t	1	2	3	5	10	20	30	
Test load	KN	14.71	29.42	44.13	61.29	122.58	245.17	367.75	
Running height	m	2.5	2.5	2.5	2.5	2.5	2.5	2.5	
Min. radius curve	m	1.0	1.1	1.3	1.4	2.0	3.5	6.0	
Dimensions mm	A	a	311	327	343	355	388	449	-
		b	413	429	445	457	490	551	582
	B	246	276	332	377	424	555	710	
	C	222	263	309	353	396	498	598	
	H	125	150	171	196	190	233	285	
	S	38	38	40	42	45	58	65	
	F	1.5-3	1.5-3	1.5-3	1.5-3	1.5-3	1.5-3	1.5-3	
	M	a	64-203	88-203	100-203	114-203	124-203	136-203	-
Beam range	mm	b	64-305	88-305	100-305	114-305	124-305	136-305	175-305
		a	14.5	21.5	31	46	88	165	-
Net weight	kg	b	15.5	23	33	48	94	174	337

# SSGCT Anti-corrosion Push Trolley



**Or Blok**  
Australia  
Lifting & Hoisting Equipment

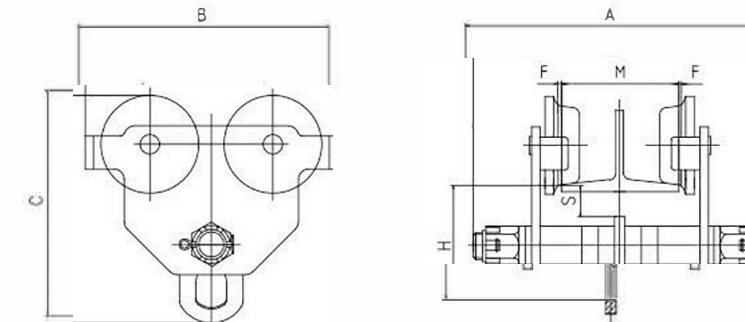

Model		GCT-1	GCT-2	GCT-3	GCT-5	GCT-10	GCT-20	GCT-30	
Capacity	t	1	2	3	5	10	20	30	
Test load	KN	14.71	29.42	44.13	61.29	122.58	245.17	367.75	
Min. radius curve	m	1.0	1.1	1.3	1.4	2.0	3.5	6.0	
Dimensions mm	A	a	311	327	343	355	388	449	-
		b	413	429	445	457	490	551	582
	B	246	276	332	377	424	555	710	
	C	222	263	309	353	396	498	598	
	H	125	150	171	196	190	233	285	
	S	38	38	40	42	45	58	65	
	F	1.5-3	1.5-3	1.5-3	1.5-3	1.5-3	1.5-3	1.5-3	
	M	a	64-203	88-203	100-203	114-203	124-203	136-203	-
Beam range	mm	b	64-305	88-305	100-305	114-305	124-305	136-305	175-305
		a	10.5	17.5	27	41	82	159	-
Net weight	kg	b	11.5	19	29	143	89	167	327