

# GRADE 80 PRODUCT CATALOGUE

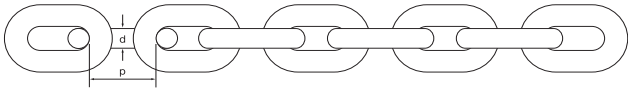

## Ti TAN G80 LIFTING CHAIN (AS2321)



Code	Chain Size	d	tol.	p	tol.	W	tol.	WLL (t)	Weight p/m (kg)
TCG8B-6	6mm	6	0.2	18.2	0.7	21	0.6	1.2	0.86
TCG8B-8	8mm	8	0.2	24	0.6	27.5	0.7	2	1.49
TCG8B-10	10mm	10	0.2	30	0.6	34.5	0.7	3.2	2.31
TCG8B-13	13mm	13	0.2	39	0.7	45	0.8	5.3	3.87

## Ti TAN G80 SINGLE RINGS C/W FLATS



### FEATURES

- Single oblong links allow flexibility in the construction of single or double chain slings including wire rope slings
- Comes with flat section
- Forged super alloy steel - quenched and tempered
- Suitable for EN818 G80 chains
- Complies with AS3776/EN1677
- Individually proof tested at 2 times WLL
- Fatigue tested at 1.5 x WLL for 20000 cycles
- 100% Magnaflux crack detection
- Yellow powder plastified finish
- Test certificates available

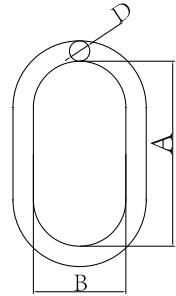

Code			Weight (kg)	WLL (t)	Dimensions (mm)		
	1-leg sling	2-leg sling			A	B	D
T487SR-87	8	7	0.38	2.6	120	70	13
T487SR-108	10	8	0.67	3.5	140	80	16
T487SR-1310	13	10	1.2	5.5	160	95	20
T487SR-1613	16	13	2.45	9.2	190	110	26
T487SR-2016	20	16	4.48	13.8	230	130	32
T487SR-2220	22	20	7.5	21.6	275	150	38

## Ti TAN G80 MULTI RINGS C/W FLATS



### FEATURES

- Master link & 2 intermediate links for 2, 3 or 4 leg chain slings and wire rope slings
- Comes with flat sections on intermediate links
- Forged super alloy steel - quenched and tempered
- Suitable for EN818 G80 chains
- Individually proof tested at 2 times WLL
- Complies with AS3776/EN1677
- Fatigue tested at 1.5 x WLL for 20000 cycles
- 100% Magnaflux crack detection
- Yellow powder plastified finish
- Test certificates available

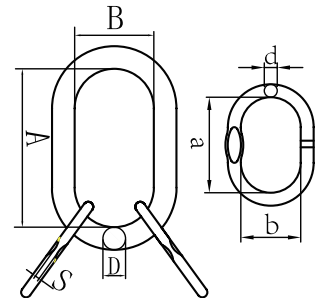

Code	3 and 4-leg slings	Weight (kg)	WLL (t)	Dimensions (mm)					
				A	B	D	a	b	d
T488MR-08	8	1.9	3.5	160	95	20	110	60	13
T488MR-10	10	2.82	5.5	160	95	22	140	80	16
T488MR-13	13	4.87	9.2	190	110	26	160	95	20
T488MR-16	16	9.38	13.8	230	130	32	190	110	26
T488MR-20	20	15.28	21.6	275	150	38	230	130	30

## AMG BRAND G80 CHAIN CONNECTING LINK

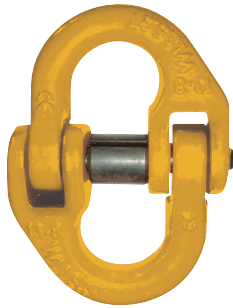

### FEATURES

- Forged super alloy steel - quenched and tempered
- Suitable for EN818-2 G80 chains
- Individually proof tested at 2 times WLL
- All load pins are 100% individually inspected and tested
- Complies with AS3776/EN1677
- Fatigue tested at 1.5 x WLL for 20000 cycles
- 100% Magnaflux crack detection
- Yellow powder plastified finish
- Test certificates available

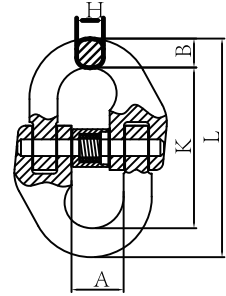

Code	Weight (kg)	WLL (t)	A	B	W I	K	H
AMG074HL-6	0.08	1.2	15	7.5	58	42	7
AMG074HL-7/8	0.146	2	18	9.5	79.5	60.5	8.5
AMG074HL-10	0.3	3.2	25	12	90.5	68	11.5
AMG074HL-13	0.65	5.3	29	15	117	87	15
AMG074HL-16	1.15	8	34.5	19.8	148	108.4	19.8
AMG074HL-18/20	2.1	12.5	41	24	169.5	121.5	24

## TITAN CHAIN CONNECTOR



### FEATURES

- Chain connectors provide fast, easy assembly without the need for special tools
- Designed for attaching hooks, master links and other fittings to Grade 80 alloy steel chains
- Individually proof tested at 2 times WLL
- Individually magnetic particle crack tested
- Complies with AS3776/EN1677
- Yellow powder plastified finish
- Test certificates available

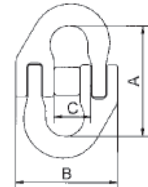

Code	Size	Weight (kg)	WLL (t)	Dimensions (mm)		
				A	B	C
TCL 6	6	0.14	1.2	44	40	16
TCL 7/8	8	0.15	2	54	52	19
TCL 10	10	0.32	3.2	64	65	25
TCL 13	13	0.68	5.3	84	82	30
TCL 16	16	1.26	8	104	103	36
TCL 20	20	2.02	12.5	123	120	44
TCL 22	22	3.18	15	153	139	51
TCL 26	26	4.52	21.2	160	166	57
TCL 32	32	8.2	31.5	175	195	68

## TITAN CLEVIS TRADITIONAL SELF-LOCKING HOOK



### FEATURES

- Self-locking hooks are traditionally sized hooks with release mechanism.
- The clevis enables a direct connection to G80 chain
- Once opened the hook will remain open until load is engaged
- Complies with AS3776/EN1677
- Fatigue tested at 1.5 x WLL for 20000 cycles
- 100% Magnaflux crack detection
- Yellow powder plastified finish
- Test certificates available
- Individually proof tested

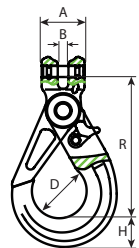

Code	Weight (kg)	WLL (t)	Dimensions (mm)				
			A	B	H	D	R
T335CSLH-6	0.4	1.2	32	7.5	20	34	96
T335CSLH-7/8	0.7	2	36	9	24	46	118.5
T335CSLH-10	1.5	3.2	46	12	28	58	144
T335CSLH-13	2.7	5.3	59	15	40.5	69	181.5
T335CSLH-16	5.6	8	70	17.5	50.5	86	216
T335CSLH-18/20	10.5	12.5	81	25	62	92	238

## TiTAN G80 EYE TRADITIONAL SELF LOCKING HOOK



### FEATURES

- Large eye to enable assembling to wire rope (thimble)
- Flat section on eye to enable assembly to Omega links
- Once opened the hook will remain open until load is engaged
- Complies with AS3776/EN1677
- Fatigue tested at 1.5 x WLL for 20000 cycles
- 100% Magnaflux crack detection
- Yellow powder plastified finish
- Test certificates available
- Individually proof tested

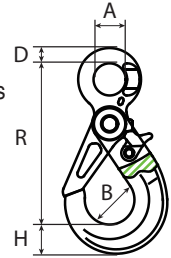

Code	Weight (kg)	WLL (t)	Dimensions (mm)				
			A	B	D	R	H
T336ESLH-6	0.5	1.2	22	34	10.5	110.5	20
T336ESLH-718	0.8	2	25	46	12	136	24
T336ESLH-10	1.5	3.2	32	58	13	169	28
T336ESLH-13	2.8	5.3	40	69	16.5	208	40.5
T336ESLH-16	5.4	8	50	86	20	254.5	50.5
T336ESLH-18120	10	12.5	61	92	26.5	290	62
T336ESLH-22	13.4	15	72	98	30	320	65

## TiTAN G80 SWIVEL SELF LOCKING HOOKS W/BEARING



### FEATURES

- Large eye to enable assembling to wire rope (thimble)
- Flat section on swivel eye for attaching Omega links
- Includes ball bearing in the swivel enabling smooth and easy rotation under load
- Complies with AS3776/EN1677
- Fatigue tested at 1.5 x WLL for 20000 cycles
- 100% Magnaflux crack detection
- Yellow powder plastified finish
- Test certificates available
- Individually proof tested

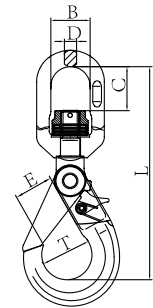

Code	Weight (kg)	WLL (t)	Dimensions (mm)					
			B	C	D	L	T	E
T042SSLHWB-6	0.71	1.2	32.5	34.8	11.5	163.3	34	27
T042SSLHWB-7/8	1.1	2	36	40	13	195.2	46	35
T042SSLHWB-10	2	3.2	42	48	15.5	237	56	44
T042SSLHWB-13	4	5.3	50	58	17	282	69	53
T042SSLHWB-16	7.3	8	61	61	21.5	341.5	86	60

## TiTAN G80 CLEVIS SELF LOCKING HOOKS WITH GRIP LATCH



### FEATURES

- Quick release trigger mechanism
- Special grip latch in forging for additional secure closing and safety
- Complies with AS3776/EN1677
- Fatigue tested at 1.5 x WLL for 20000 cycles
- 100% Magnaflux crack detection
- Yellow powder plastified finish
- Test certificates available
- Individually proof tested

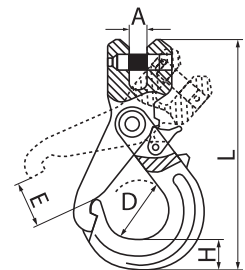

Code	Weight (kg)	WLL (t)	Dimensions (mm)				
			A	H	E	L	D
T078CSLHGL-7/8	0.6	2	9.5	21.5	36	149	40
T078CSLHGL-10	1.1	3.2	12	26.2	44	189	50
T078CSLHGL-13	2	5.3	15	31	54	229	60
T078CSLHGL-16	4.2	8	18	39.5	63	270	70

## TiTAN G80 EYE SELF LOCKING HOOKS WITH GRIP LATCH



### FEATURES

- Will remain closed until the quick release trigger is pressed
- Once opened the hook will remain open until load is engaged
- Large eye to enable assembling to wire rope (thimble)
- Flat section on eye for attaching Omega links
- Yellow powder plastified finish
- Special grip latch in forging for additional secure closing and safety
- Complies with AS3776/EN1677
- Fatigue tested at 1.5 x WLL for 20000 cycles
- 100% Magnaflux crack detection
- Test certificates available
- Individually proof tested

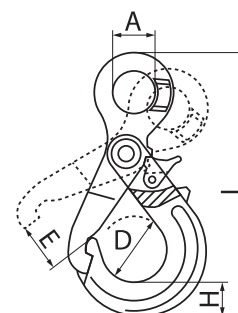

Code	Weight (kg)	WLL (t)	Dimensions (mm)				
			A	H	E	L	D
T077ESLHGL-7/8	0.75	2	25	21.5	34	163	40
T077ESLHGL-10	1.2	3.2	32	26.2	42	201.5	50
T077ESLHGL-13	2	5.3	40	31	50	243.5	60
T077ESLHGL-16	4.1	8	50	39.5	60	298	70

## TiTAN G80 SWIVEL SELF LOCKING HOOKS WITH GRIP LATCH (NO BEARING)



### FEATURES

- Will remain closed until the quick release trigger is pressed
- Once opened the hook will remain open until load is engaged
- Large eye swivel for easy assembly to wire rope (thimbles)
- Flat section on swivel eye for attaching Omega links
- 100% Magnaflux crack detection
- Special grip latch in forging for additional secure closing and safety
- Complies with AS3776/EN1677
- Fatigue tested at 1.5 x WLL for 20000 cycles
- Yellow powder plastified finish
- Test certificates available
- Individually proof tested

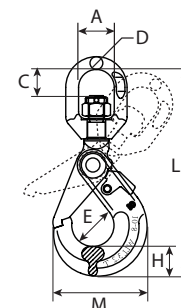

Code	Weight (kg)	WLL (t)	Dimensions (mm)						
			A	C	D	H	E	L	M
T343SSLHGL-6	0.68	1.2	32.5	23	11	19.5	39	176	76
T343SSLHGL-7/8	0.97	2	35.5	26	12.5	21.5	40	193.5	83
T343SSLHGL-10	1.83	3.2	42	33	15	26.5	50	233	101
T343SSLHGL-13	3.3	5.3	50	39	18	30.5	60	273	121

## TiTAN G80 SWIVEL SAFETY HOOK WITH CAST LATCH (NO BEARING)



### FEATURES

- Large eye swivel for easy assembly to wire rope (thimbles)
- Flat section on eye to enable assembly to Omega links
- Individually proof tested
- Heavy duty cast safety latch
- Spare latch kits available
- Complies with AS3776/EN1677
- Fatigue tested at 1.5 x WLL for 20000 cycles
- 100% Magnaflux crack detection
- Yellow powder plastified finish
- Test certificates available

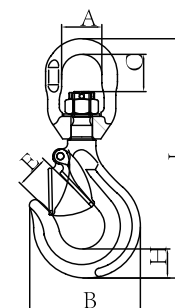

Code	Weight (kg)	WLL (t)	Dimensions (mm)					
			A	B	R	H	C	L
T268SSH-7/8	0.85	2	36	88.5	27	23.5	26	190
T268SSH-10	1.54	3.2	42	104.5	32	29.5	34	233
T268SSH-13	3.04	5.3	49	135	40	38	41	291.5
T268SSH-16	5.36	8	61	161	45	45.4	53	352

## TiTAN G80 CLEVIS SLING HOOK WITH SAFETY LATCH



### FEATURES

- Forged super alloy steel - quenched and tempered
- Heavy duty cast safety latch
- Complies with AS3776/EN1677
- Individually proof tested
- Fatigue tested at 1.5 x WLL for 20000 cycles
- 100% Magnaflux crack detection
- Spare latch kits available
- Yellow powder plastified finish
- Test certificates available

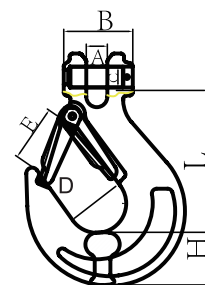

Code	Weight (kg)	WLL (t)	Dimensions (mm)					
			A	B	R	H	C	L
T012CSH-6	0.32	1.2	8	32	35	23	76	26
T012CSH-7/8	0.48	2	9.5	37	37	32.5	85.5	29
T012CSH-10	0.95	3.2	13	49	46	35	104	39
T012CSH-13	1.8	5.3	16.5	56.5	56	42.5	128	47
T012CSH-16	3.4	8	21.5	70.5	60	54	150	55
T012CSH-20	6	12.5	24	77	79	58	180	61

## TiTAN G80 EYE SLING HOOK WITH SAFETY LATCH



### FEATURES

- Forged super alloy steel - quenched and tempered
- Cast safety latch
- Complies with AS3776/EN1677
- Individually proof tested
- Fatigue tested at 1.5 x WLL for 20000 cycles
- 100% Magnaflux crack detection
- Spare latch kits available
- Yellow powder plastified finish
- Test certificates available

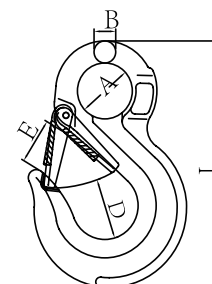

Code	Weight (kg)	WLL (t)	Dimensions (mm)				
			B	E	D	A	L
T013ESH-6	0.3	1.2	9	24	21	20	108
T013ESH-7/8	0.4	2	11	30	26	25	133
T013ESH-10	0.9	3.2	15	34	39	38	167
T013ESH-13	1.7	5.3	19	39	54	43	213
T013ESH-16	3.2	8	23	46	64	50	255
T013ESH-20	5.8	12.5	24	40	80	62	305

## TiTAN G80 CLEVIS SHORTENING CRADLE GRAB HOOK



### FEATURES

- Forged super alloy steel - quenched and tempered
- Complies with AS3776/EN1677
- Fatigue tested at 1.5 x WLL for 20000 cycles
- 100% Magnaflux crack detection
- Spare load pin kits available
- All load pins are tested and inspected
- Yellow powder plastified finish
- Test certificates available
- Individually proof tested

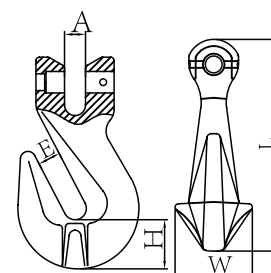

Code	Weight (kg)	WLL (t)	Dimensions (mm)				
			E	A	H	W	L
T086CSGH-6	0.25	1.2	8.3	8	17.7	26.7	75
T086CSGH-7/8	0.32	2	11	9.5	18.5	33.5	89
T086CSGH-10	0.73	3.2	13	12.5	29	46	126
T086CSGH-13	1.6	5.3	16.5	15	42.5	57.5	163.5
T086CSGH-16	2.8	8	19	18.5	45.5	74	183.5
T086CSGH-20	5	12.5	24	23	56	74	219

## TiTAN G80 EYE SHORTENING CRADLE GRAB HOOK



### FEATURES

- Forged super alloy steel - quenched and tempered
- Connects directly to a chain connector
- Individually proof tested
- Complies with AS3776/EN1677
- Fatigue tested at 1.5 x WLL for 20000 cycles
- 100% Magnaflux crack detection
- Yellow powder plastified finish
- Test certificates available
- Individually proof tested

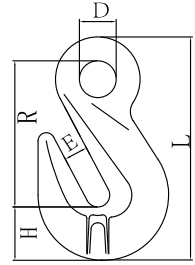

Code	Weight (kg)	WLL (t)	Dimensions (mm)				
			E	D	H	R	L
T085ESGH-6	0.14	1.2	8	13.5	17.9	51.4	75.3
T085ESGH-7/8	0.245	2	10.8	18	20	61.5	91.2
T085ESGH-10	0.65	3.2	13	20	29	80	122
T085ESGH-13	1.39	5.3	16.5	26	42.8	99.7	158
T085ESGH-16	2.2	8	20	30.5	47.7	104	169
T085ESGH-20	4.6	12.5	25	37.5	56	140	219

## TiTAN G80 CLEVIS CHAIN CLUTCH



### FEATURES

- Forged super alloy steel - quenched and tempered
- Flexibility to shorten chain slings directly to chain
- Connects directly to a chain connector
- Complies with AS3776/EN1677
- Individually proof tested
- Fatigue tested at 1.5 x WLL for 20000 cycles
- 100% Magnaflux crack detection
- Yellow powder plastified finish
- Test certificates available

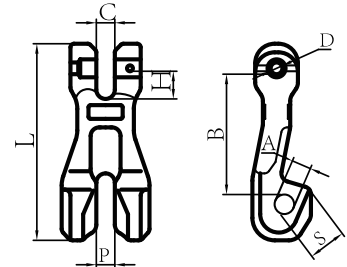

Code	Weight (kg)	WLL (t)	Dimensions (mm)							
			P	C	A	B	H	S	L	D
T073CC-6	0.17	1.2	7.5	7.5	8	44	10.3	12	73.5	7.8
T073CC-7/8	0.37	2	9.5	9.5	10.5	61.7	14	17	101	9.2
T073CC-10	0.97	3.2	13	13	12.4	92	18.4	28	138	13.2
T073CC-13	2.01	5.3	16.5	16.5	16	115	22.7	34.5	177	16.2
T073CC-16	3.32	8	21	21	19.5	143	28.5	40	220	20

## TiTAN G80 WELD-ON RING C/W SPRING



### FEATURES

- Forged super alloy steel - quenched and tempered
- Used as a fixed anchor point for spreaderbeam attachment
- Used as an anchor point for load restraint applications
- Spring inside for better pivoting control
- Complete with welding instructions
- Welded to any carbon steel surfaces as a lifting point
- Complies with AS3776/EN1677
- 100% Magnaflux crack detection
- Yellow powder plastified finish
- Test certificates available
- Safety factor of 4:1

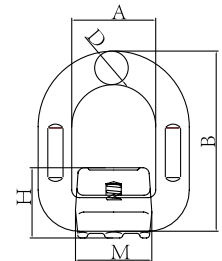

Code	Weight (kg)	WLL (t)	Dimensions (mm)				
			A	B	D	M	H
T344WODR-1T	0.4	1	41	78.5	13	37	35
T344WODR-2T	0.47	2	42	88	14	40	37
T344WODR-3T	0.69	3	45	94	17	42.5	40
T344WODR-5T	1.46	5	55	118	22	61	52
T344WODR-8T	2.5	8	70	141	26.5	70.5	57
T344WODR-15T	5.79	15	97	188	34	90	77

NB: Welding MUST be performed by a qualified welder.

## TiTAN G80 WELD-ON HOOK C/W LATCH



### FEATURES

- Versatile for general lifting and spreader beams, fixed anchor points in general lifting applications
- Forged super alloy steel - quenched and tempered
- Welding instructions available
- Comes with forged latch
- Complies with AS3776/EN1677
- 100% Magnaflux crack detection
- Yellow powder plastified finish
- Test certificates available
- Safety factor of 4:1

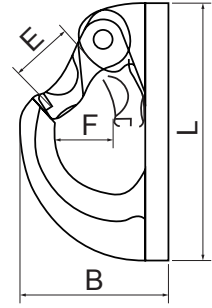

Code	Weight (kg)	WLL (t)	Dimensions (mm)			
			B	E	F	L
T106WOH-2T	0.55	2	63.5	26	26	112
T106WOH-3.2T	0.87	3.2	75	30	30	127.5
T106WOH-5.3T	1.75	5.3	92.5	35	35	160
T106WOH-8T	2.98	8	106	40	40	180
T106WOH-12.5T	6.16	10	140	51	49	236

## TiTAN G80 CONTAINER LUG L & R TYPE

### FEATURES

- Eye type suitable for lifting containers with twist lock pockets
- Forged super alloy steel - quenched and tempered
- Suitable for rope sling and G80 chain
- The large eye allows most size hooks to be attached
- Available in left (L) and right (R) hand configurations
- Complies with AS3776
- Fatigue tested at 1.5 x WLL for 20000 cycles
- 100% Magnaflux crack detection
- Yellow powder plastified finish
- Test certificates available
- Individually proof tested
- Safety factor of 4:1

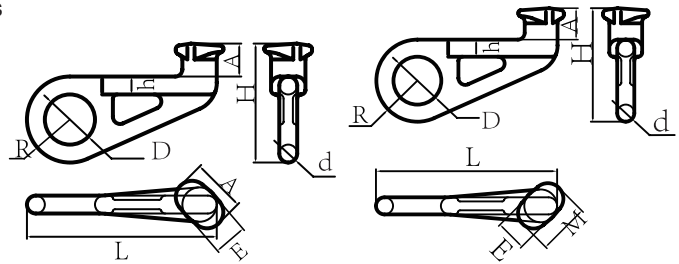

Code	Weight (kg)	WLL (t)	Dimensions (mm)								
			A	M	H	h	E	R	D	d	L
T633CL-L	4	12.5	46	75	166	25	48	60	70	25	265
T633CL-R	4	12.5	46	75	166	25	48	60	70	25	265

## TiTAN CONCRETE CLUTCHES (AS3850 SF5:1)

### FEATURES

- Used for lifting pre-cast concrete panels, construction panels and columns
- Individually proof tested and supplied with test certificate
- Component A: Cast super alloy
- Component B: Forged alloy steel
- Safety factor 5:1
- Complies with AS3850
- 100% Magnaflux crack detection
- Yellow powder plastified finish
- Each unit is marked with a unique traceable serial number

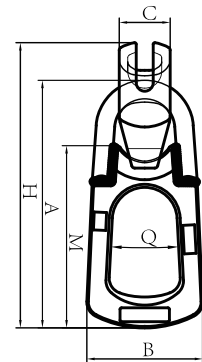

Code	Weight (kg)	WLL (t)	B.L/T	P	Dimensions (mm)			
					C	A	B	H
TCLUTCH-1.3T	0.865	1.3	6.5	148	75	33	118	6
TCLUTCH-2.5T	1.5	2.5	12.5	198	91.5	41	145	7
TCLUTCH-5T	3.1	5	25	238	118	57	170	5