

Shorteners

NEW

cromox Shortener CVE. Grade 60 tested. sand blasted

Type	W.L.L.	Dimensions mm			Weight kg
	t	d	t	a	
CVE 04	0.40	17	74	32	0.170
CVE 05	0.63	24	93	40	0.280
CVE 06	0.90	25	112	45	0.455
CVE 07	1.25	27	131	53	0.750
CVE 08	1.55	28	148	56	1.000
CVE 10	2.45	38	187	70	2.000
CVE 13	3.85	48	243	91	4.500
CVE 16	6.00	56	299	108	7.600
CVE 18	8.00	67	336	122	9.500

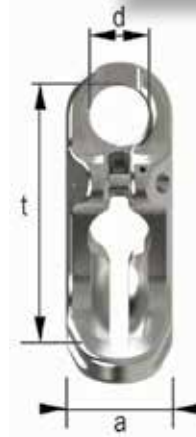

Product Benefits:

- Simple Handling.
- Safety of use through special design.
- Repositioned flat section usable in welded and modular systems.
- Weight optimised design.
- Grade 60, 4-fold safety.

Part	Material
Body	AISI 318LN
Bolt	AISI 318LN
Safety Pin	AISI 301



cromox Shortener CVED. Grade 60 tested. sand blasted

Type	W.L.L.	Dimensions mm			Weight kg
	t	d	t	a	
KW-CVED06	0.90	25	92.00	40.00	0.37
KW-CVED07	1.20	32	113.00	50.50	0.70
KW-CVED08	1.50	32	119.80	50.50	0.77
KW-CVED10	2.40	38	149.00	61.00	1.39

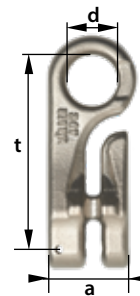

These shorteners are discontinued and are run out stock